

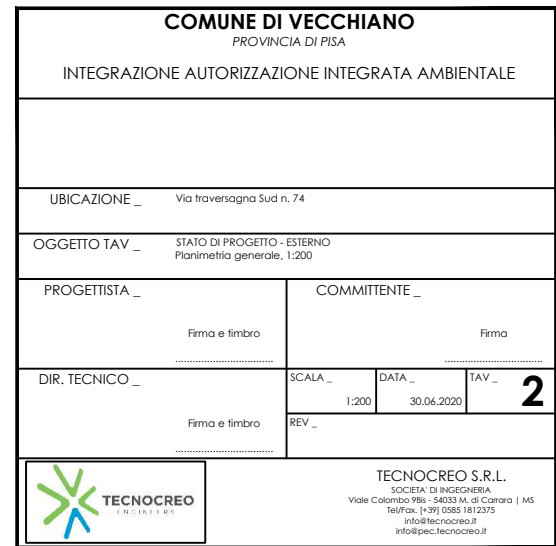

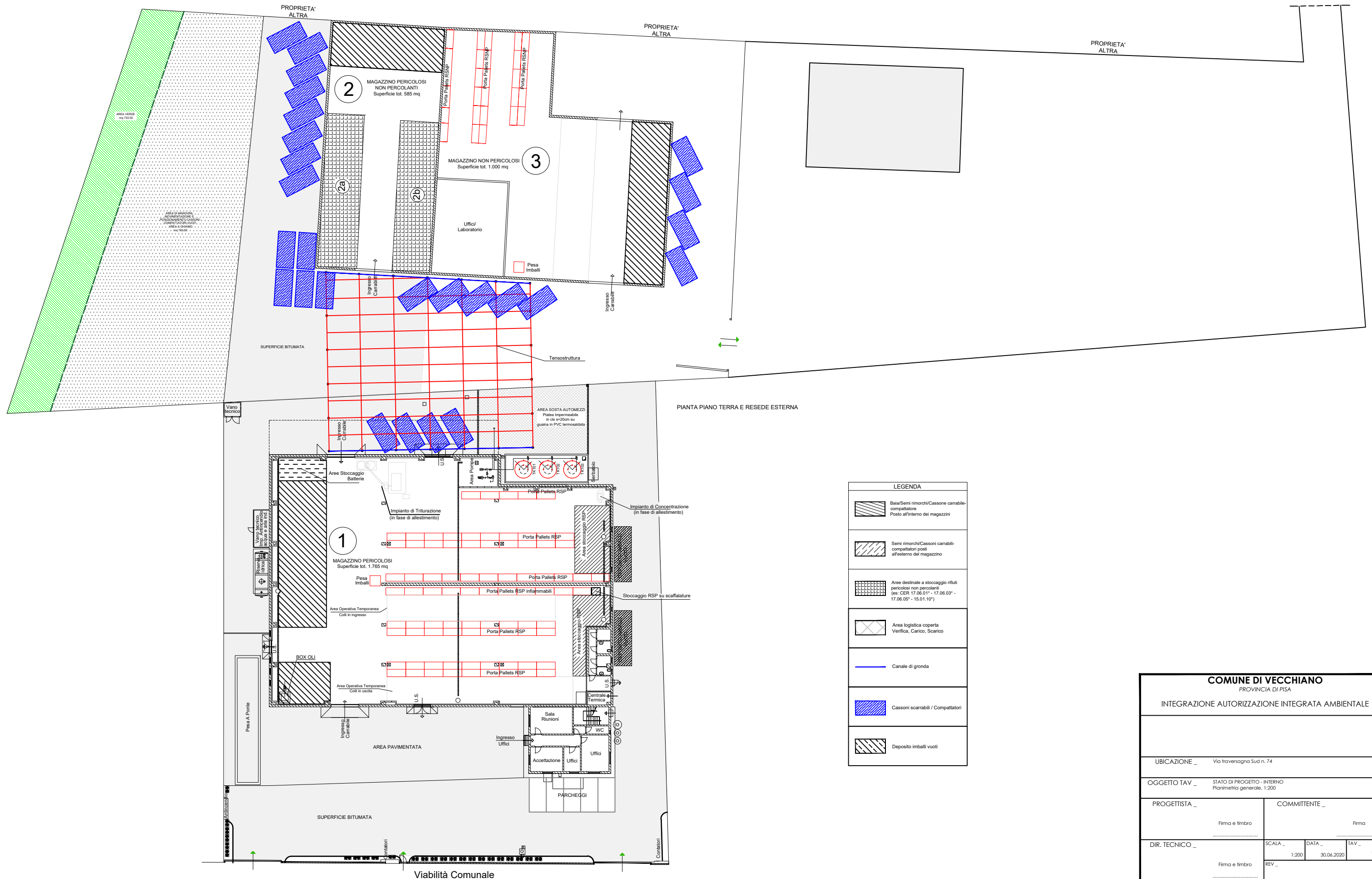





PLANIMETRIA GENERALE - scala 1:200 -



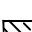

LEGENDA	
	Baia/Semi rimorchi/Cassone carrabli compattatore Posto all'interno dei magazzini
	Semi rimorchi/Cassoni carrabli- compattatori posti all'esterno del magazzino
	Aree destinate a stoccaggio rifiuti pericolosi non pericolanti (es. CER 17.06.01* - 17.06.03* - 17.06.05* - 15.01.10*)
	Area logistica coperta Verifica, Carico, Scarico
	Canale di gronda
	Cassoni scarabili / Compattatori
	Deposito imballi vuoti

<p align="center">COMUNE DI VECCHIANO PROVINCIA DI PISA</p>			
<p align="center">INTEGRAZIONE AUTORIZZAZIONE INTEGRATA AMBIENTALE</p>			
<p>UBICAZIONE _ Via traversagna Sud n. 74</p>			
<p>OGGETTO TAV _ STATO DI PROGETTO - INTERNO Planimetria generale, 1:200</p>			
<p>PROGETTISTA _</p> <p align="center">Firma e timbro</p> <p align="center">.....</p>		<p>COMMITTENTE _</p> <p align="center">Firma</p> <p align="center">.....</p>	
<p>DIR. TECNICO _</p> <p align="center">Firma e timbro</p> <p align="center">.....</p>		<p>SCALA _ DATA _ TAV _</p> <p align="center">1:200 30.06.2020</p>	<p align="center">4</p>
 <p>TECNOCREO FIRENZE</p>		<p align="center">TECNOCREO S.R.L. SOCIETA' DI INGEGNERIA Viale Colombo 98b - 54033 M. di Carrara (MS) Tel/Fax. (+39) 0585 1812375 info@tecnocreo.it info@pec.tecnocreo.it</p>	